

## SAVIO WALL HUNG

Code: CAWH45-1200

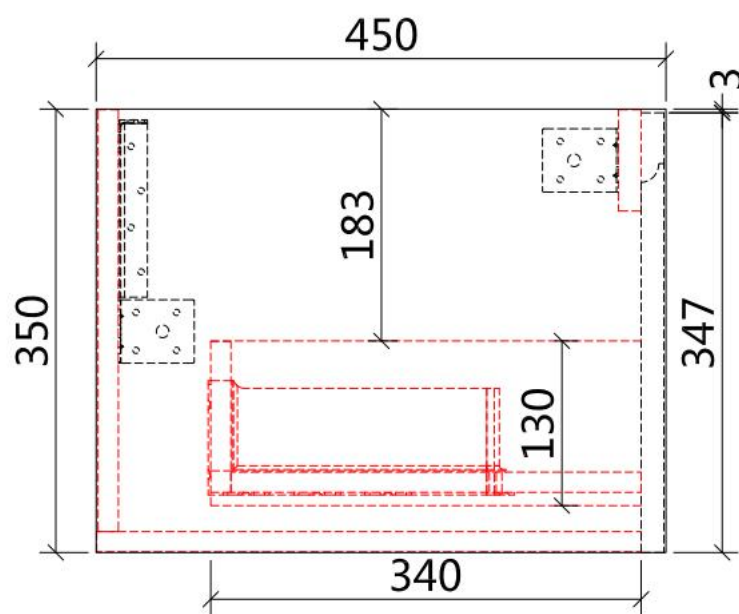
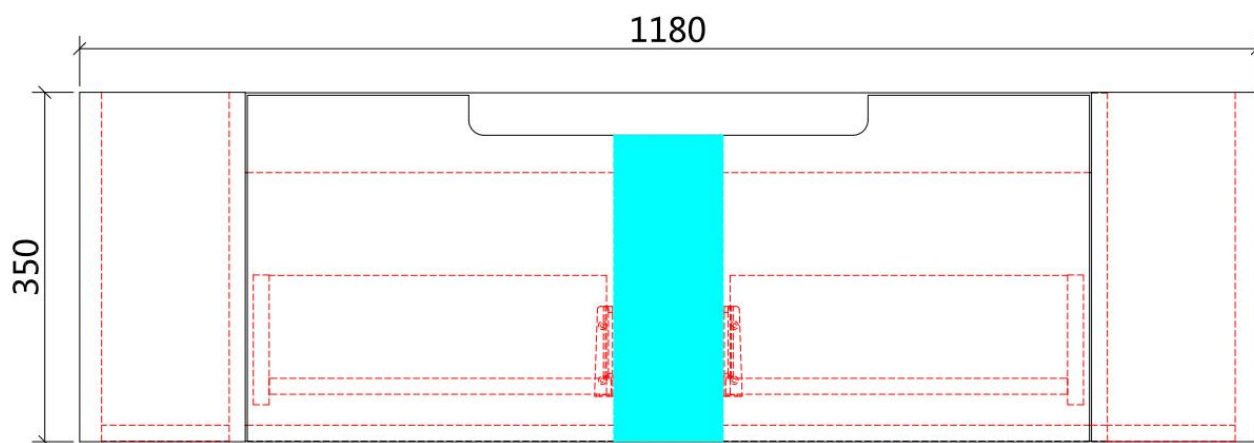

### Features:

- All-drawers model with curved feature ends.
- Premium-grade, durable timber plywood
- Contemporary V-groove in matte white polyurethane finish
- Hettich Quadro S full extension, soft close drawer runners
- Drawer Organiser included
- Hettich Quadro S full extension, soft close drawer runners
- Premium graphite interior

