

## EXTENDED LEVER BASIN MIXER

CODE:

LIFE<sub>ASSIST</sub> basin mixer

JTL123CHLF

### FEATURES

- Special purpose basin mixer tap with a fixed spout
- Extended lever design - suitable for assisted living installations
- May be installed in compliance with AS1428.1 for Special Needs applications
- 40mm ceramic disc provides accurate flow and mixing control
- Durable chrome finish with Lead Free DZR brass construction

### MODEL

LIFE <sub>ASSIST</sub> basin mixer	Chrome	JTL123CHLF
------------------------------------	--------	------------

### WARRANTY

Tapware 20 year replacement

-refer to T&Cs at [www.johnsonsuiss.com.au](http://www.johnsonsuiss.com.au)



### PRODUCT DIMENSIONS

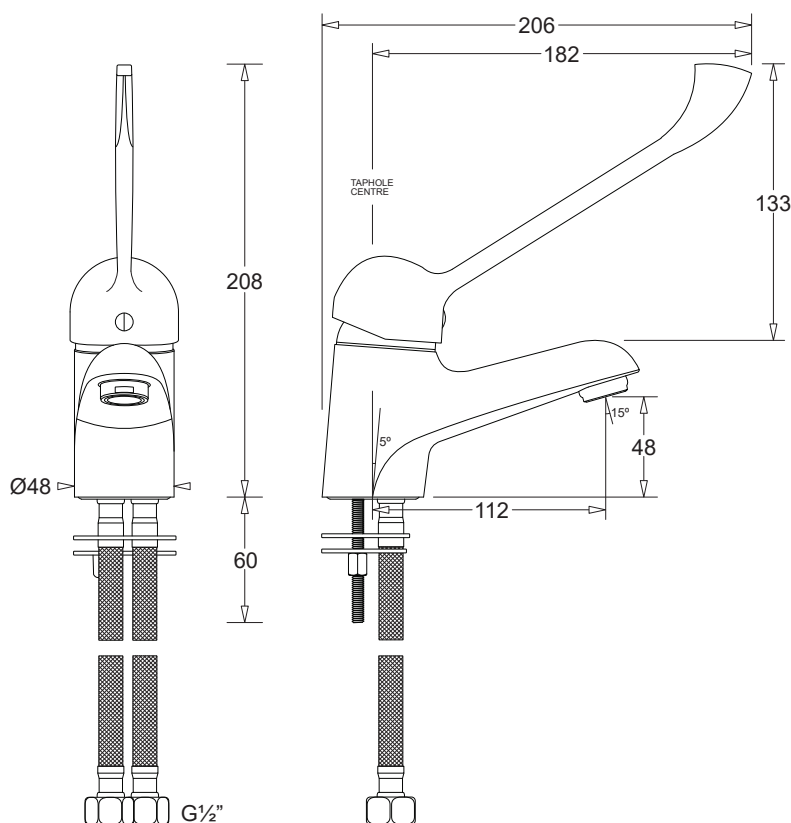

## TECHNICAL DATA SHEET

SUPERSEDES ALL PREVIOUS ISSUES

All dimensions are in millimetres and are subject to normal manufacturing variation.  
As product development is ongoing BPA reserves the right to vary specifications without notice.  
Bathroom Products Australia Pty Ltd ABN 87 079 297 617

**JohnsonSuisse**  
Bathroom Solutions

2/97 Banksia St.,  
Botany, NSW 2019  
TEL: 1300 717 717

[www.johnsonsuiss.com.au](http://www.johnsonsuiss.com.au)  
1124